

MASON



BACK STREET
SHEDDEN ONT

MAY 18, 1918



2006

Some Changes in Shedden

The Bank of Commerce moved into its new quarters on the south side of the highway in 1951.

The Southwold and Dunwich Telephone Company purchased the building vacated by the Bank of Commerce, using the first floor for business and having an apartment for the chief operator upstairs. This is the old Sterling Bank building.

In January 1966 the Bell Telephone Company took over the Southwold and Dunwich Telephone Company and built their dial operating building on the east side of the Union Road on property purchased from Matthew Ahara. Bell Canada sold the Sterling Bank building to the department of Highways which demolished the building, leaving only the small brick building which houses the library.

Palmer Brothers operate a Red & White Store in the entire block once owned by L. D. Palmer and George Braddon.

The post office formerly housed in Palmers Store now occupies a new building on the north west side of the highway next to the residence of Mrs. Hannah Schram. Matthew Ahara was the postmaster for 20 years and the present postmaster is Mrs. Gerald (Maggie) Moore.

The Horton Block now houses the Pro Hardware Store owned by Charles Judge. This property was owned by W. H. Morrison for many years and then the hardware store was operated by his nephews Lloyd and Leslie Atkinson. This store was also operated by Leo Fillmore and Ralph Mercer. A T.V. repair shop was operated in the rear of the store for several years by Donald McArthur. Mrs. Smith sold her adjoining grocery store to Mr. Judge in 1978 to enlarge his hardware store.

Changes in Shedden continued

The lumber yard owned by A. A. Silcox and sons Hugh and Lawrence ceased operation and the wooden lumber sheds were torn down. The cement block building was taken over by a T.V sales and repair shop operated by James Harvey and Leno Lattanzio. Later Leno operated it alone. Now, (1979) it is a small engine repair shop operated by Steve Annett.

The former garage built by A. E. Orchard on the north east corner of the highway is now owned by Dr. D.A. Monteith who has his office in the building.

A funeral home was operated for many years in a building now vacant on the north west side of the Union Road. R. L. Prevett, now of West Lorne and then Lloyd Rankin were the last two funeral directors. It was sold to A. A. Silcox who used it as an auction room and storage for antiques. His son Hugh was the auctioneer. The front of the building was used for a time as an office by D. A. Monteith and then Lawrence Silcox used it as an antique shop. In November 1979 the building is vacant and for sale.

The grist mill and seed cleaning plant on the north west side of the Union road was operated by Ed Down and then E. L. McCall. It has been torn down and a new home built on the property.

Compiled by Mrs. Margaret Turner
November 1979.

ADDITIONAL CHANGES IN SHEDDEN

Mrs. Smith's Store. In 1947 Nellie Sells sold this store on the south corner of number 3 highway and the Union Road to Les and Bessie Grieve. The next owners were Bill and Doris Hicks , Mr. Hedley and then Clair and Edith Smith. In 1978 Mrs. Smith sold her store to Charles Judge who used it to enlarge his hardware store next door. In 1984 this part of the store became the Shedden Branch of the Elgin County Library.

A. A. Silcox lumberyard building. After Steve Annett left this building Ken Fournie operated a garden tractor and small equipment shop here for a short time. The building was purchased by Jack Hyde who operates a used furniture and appliance business and also sells collectibles.

A. E. Orchard garage. Dr. D. A. Monteith owned this property for several years and had his office in it. In 1985 he sold the property to the Township of Southwold who had the building demolished. Dr. Monteith had his office temporarily in the back of the firehall across the street. In 1986 a new medical building named for Dr. Monteith will be built on this property, the north corner of highway three and Union Road.

Shedden Library building. This small brick building on the west corner of highway three and the Union Road was torn down in 1985 after the library moved to new quarters. In 1986 the Township of Southwold is building an extension to the fire hall on the spot where the old library building stood. This extension will house the new Southwold Fire Department rescue unit.

Shedden Womens' Institute

Additional changes continued

Carman White Shell Service Station. This service station once known as the smallest service station on number three highway was torn down in 1979 by Mr. White's nephew, Gary Carr. In 1980 the Village Boutique craft shop was built on this property and is operated by Mrs. Gary Carr the former Eileen Koyle of Shedden.

S. S. # 9 Shedden School. This school was closed in 1966 and the children bused to Southwold Central School. Bob Draper operated a welding shop in the school building for several years and, then an artist had his studio in the building for a few years. He sold the property to Gary and Eileen Carr in 1982. After extensive renovations Mr. & Mrs. Carr opened the Old School House Tea Room on January 20, 1984 .

Grain Elevator. The original grain elevator was built by George Casey MP in Shedden after the Canada Southern Railroad was built in 1871 . These elevators were later purchased by John McLandress who operated them for many years. His son, William McLandress of Fingal, then operated the elevator until after the second world war. They sold Purina feeds and Frank Miller ran the feed mill. Sydney Orchard then ran the elevator for a short time, selling out to St. Clair Grains operated by Ray Shaw. The property was then sold to Scotch Fertilizer of Glencoe who tore down the elevators and built a fertilizer plant there. In 1986 the buildings are vacant.

South quarter lot 19 NNBTR. In the late 1970's Ken Fournie purchased this property, excluding the house, from Mrs. James Milligan. Mr. and Mrs. Milligan had operated a garage and lunch room on the property. The business started in the former garage building is known as Shedden Farm Equipment and Shedden Womens' Institute

Additional changes continued

sell New Idea, White, Cockshutt and British Leyland farm equipment and parts. The business grew quickly and two additions have been made to the original service station building. Mr. Fournie has also purchased the Orchard farm, lot 19 SNBTR across the road where he has equipment for sale in the front field.

Funeral Home. Mr. Harold Albright of Wallacetown purchased this property from Lawrence Silcox in 1982. He operated a variety store in this building until January 1985. The property is now vacant and for sale.

SHEDDEN CEMETERY. A one acre plot on lot 15 W $\frac{1}{4}$ SNBTR next to Shedden cemetery was purchased from Mr. Steve Stoss in 1983 and has been incorporated into the cemetery.

Palmer Brothers store. In 1981, an old building at the rear of the store which had housed at various times the Shedden post office, the Shedden library and a doctor's office was torn down. A 1500 square foot addition was then built on the back of the store.

Judges' Hardware. An old barn behind the hardware store was torn down in the spring of 1986.

Maybee Cold Storage. In 1980 the cold storage business ceased operation.

Fairgrounds barn. In late 1984 the newest barn at the fairgrounds and several horses were destroyed by fire. The barn was not rebuilt.

Additional changes continued

sell New Idea, White, Cockshutt and British Leyland farm equipment and parts. The business grew quickly and two additions have been made to the original service station building. Mr. Fournie has also purchased the Orchard farm, lot 19 SNBTR across the road where he has equipment for sale in the front field.

Funeral Home. Mr. Harold Albright of Wallacetown purchased this property from Lawrence Silcox in 1982. He operated a variety store in this building until January 1985. The property is now vacant and for sale.

SHEDDEN CEMETERY. A one acre plot on lot 15 W $\frac{1}{4}$ SNBTR next to Shedden cemetery was purchased from Mr. Steve Stoss in 1983 and has been incorporated into the cemetery.

Palmer Brothers store. In 1981, an old building at the rear of the store which had housed at various times the Shedden post office, the Shedden library and a doctor's office was torn down. A 1500 square foot addition was then built on the back of the store.

Judges' Hardware. An old barn behind the hardware store was torn down in the spring of 1986.

Maybee Cold Storage. In 1980 the cold storage business ceased operation.

Fairgrounds barn. In late 1984 the newest barn at the fairgrounds and several horses were destroyed by fire. The barn was not rebuilt.

1819

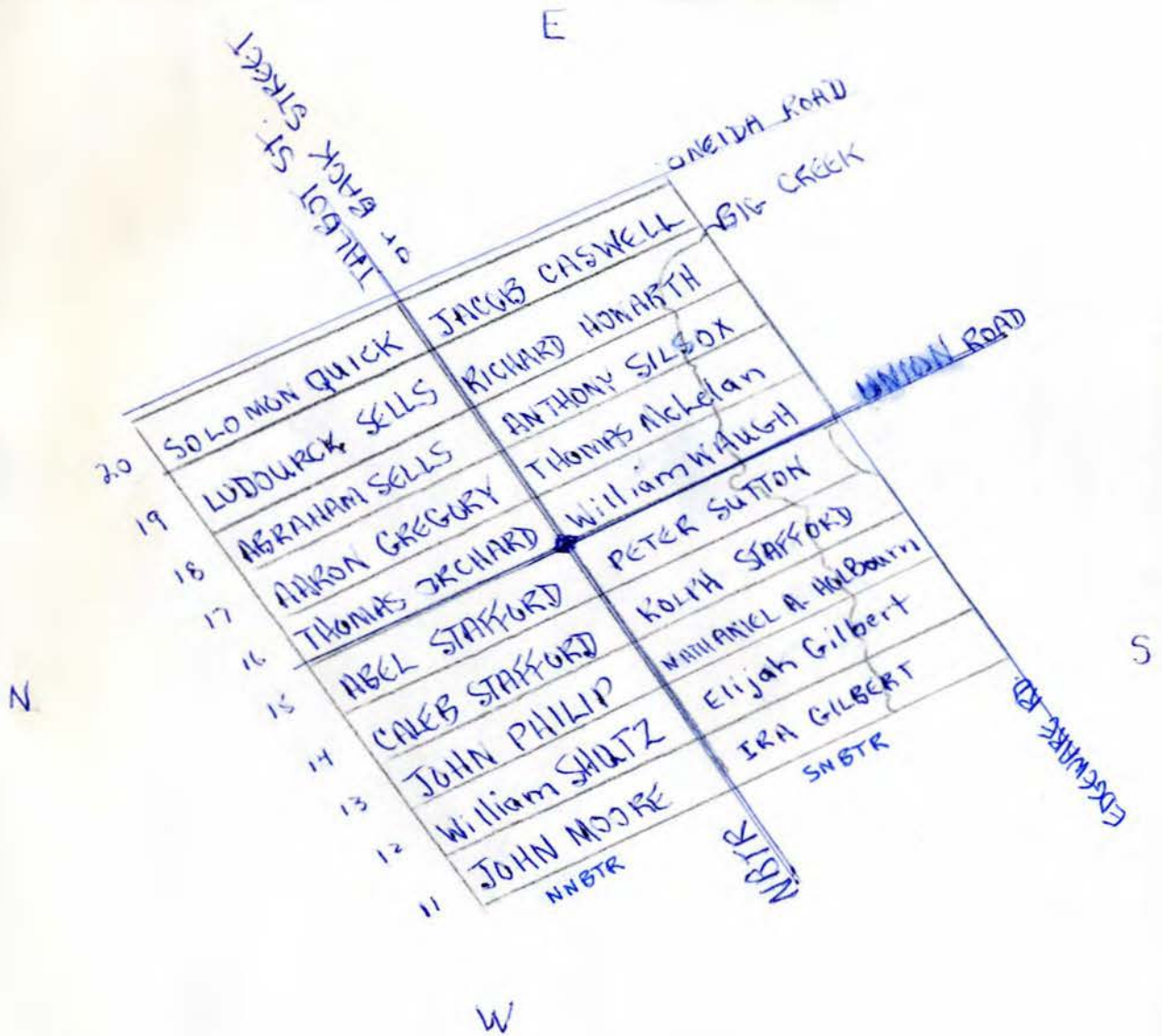

From the Lewis Burwell 1819 map of the Talbot Settlement in the Provincial Archives, Toronto.

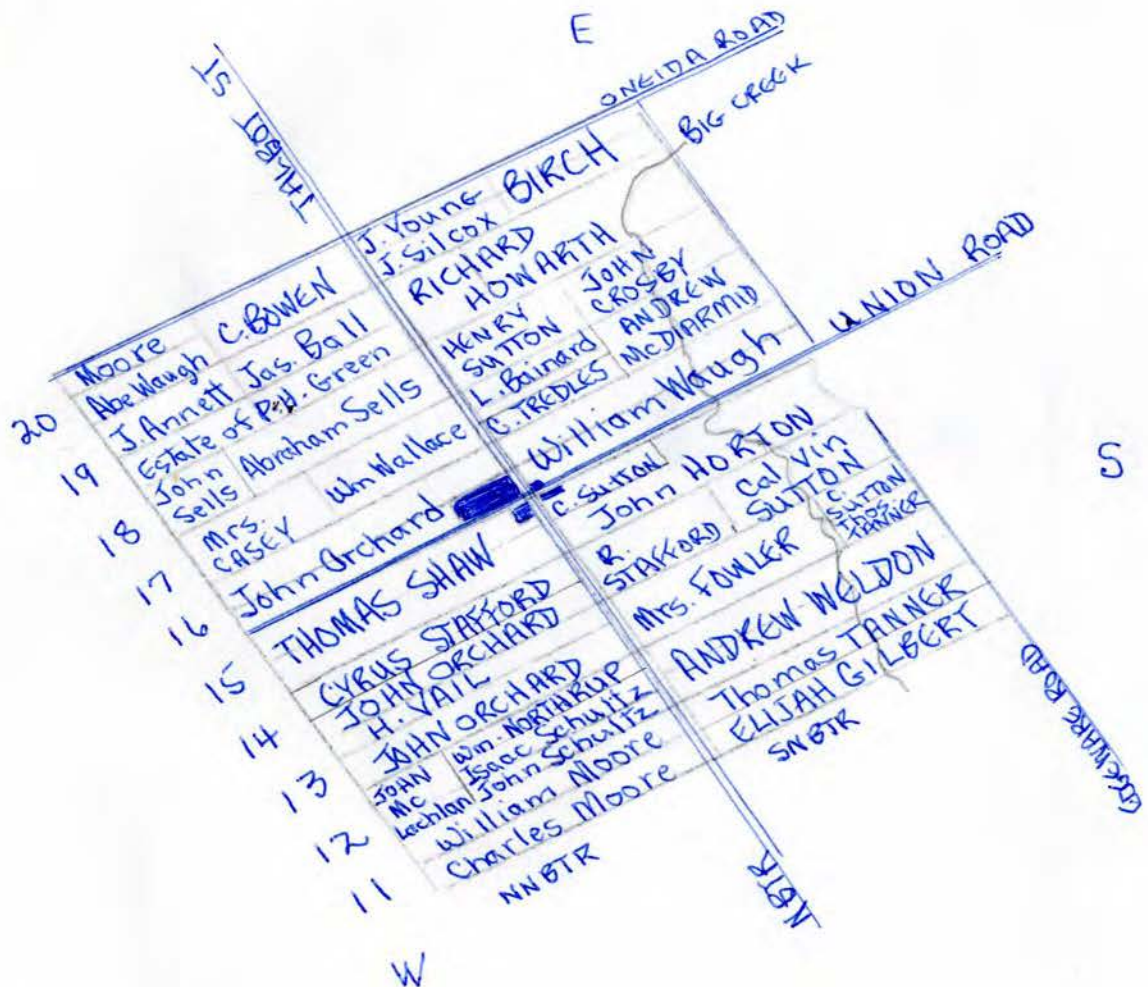

From the Tremain Map of 1864 in the Talbot Room of the Elgin County Pioneer Museum in St. Thomas.



Map of Southwold township (central area) taken from the Elgin County Atlas of 1877. The area covered by the Shedden Tweeds-History Book is outlined in green.



MARY CATHERINE (MAMIE) WAUGH TEETZEL

Mrs. Teetzel is a granddaughter of William Waugh one of the first settlers in the Shedden area. This picture was taken on Mrs. Teetzel's 80th birthday, May 1968. Miss Eva Morrison, life member of Shedden Women's Institute is on the left.

William Waugh, born 16 July 1789 in Symington Parish, Lanarkshire Scotland, came to Canada in 1805 to the Long Point Settlement. In 1816 he journeyed to the Talbot Settlement where he received a grant of 200 acres on Lot 16, SNBTR. He married, on 23 November 1830, Miss Letitia Bodine born 22 August 1806 in Pennsylvania. The Bodines lived on the NW $\frac{1}{4}$ lot 17 NEBTR fronting on the Edgeware Road. The parents of Letitia were Abraham Bodine and Zillah Taylor Bodine buried June 1846 and April 1837 respectively in the family plot on their farm. The family burial plot was on the hill facing the present home of Donald and Beth Vicary. The plot has been plowed over and no trace of it remains.

William and Letitia Waugh had eight children:

Zillah born	22 June 1833,	married John McLay
Nancy	6 Sept 1834,	Samuel Sutton
Marion	20 Mar 1837,	George Miller
Sarah	24 May 1839,	R. Duncan
Martha	9 Aug 1840,	Single
Abram	24 Jan 1843,	Mary McAlpine and _____ Robb
William	1 Nov 1846,	Alma Fowler and Hattie Fowler
Alexander	23 May 1848,	Charlotte Miller
Abram Bacchus	8 Feb 1844,	adopted child

Nancy, Marion, Sarah, William and Alexander moved to the United States. Mr. and Mrs. Wm. Waugh, Zillah, Martha and Abram are buried in Frome cemetery.

SW $\frac{1}{2}$ Lot 16

William Waugh died 7 November 1876 and his farm was divided in half, Abram received the SW $\frac{1}{2}$ along the Union Road and William received the NE $\frac{1}{2}$. Abram married Mary McAlpine on 29 May 1873 and they had six children:

Adella Vinnetta married MacKenzie
John Arthur
"Sir" Hilton
Herman
Charles Austin
Mary Catherine (Mamie) married Fred Teetzel

The boys in the family suffered from diabetes and all had died by their early twenties. Della married Mr. MacKenzie and moved to Detroit, Michigan; she had no children. Mamie was her father's "right-hand man" and worked right along with him on the farm. Mamie's mother died when she was quite young and her father married a Robb from Ilderton, a cousin of Mrs. Andrew McDiarmid, next farm. The fine yellow brick house on the farm was built in 1888, the year Mamie was born. It had four bedrooms upstairs, double living rooms at the front downstairs and a large dining room and small bedroom. The kitchen with a bedroom upstairs and a woodshed were built on the back. Part of the west living room was later made into a bathroom.

Abram Waugh died 15 June 1919 and left his farm to his daughter, Mamie. Mamie had married Fred Teetzel and they lived on lot 18 SEBTR. In 1919 Gertrude Baird married Blake Horton and they rented the Waugh farm for a year and a half before their daughter Dorothy (Mrs. Clarence Palmer) was born. They bought their own farm and Mamie, her husband and young son, Beverly, moved to the Waugh farm.

The barn on the Waugh farm is quite unusual for this area; it is a two-bay Pennsylvania-style barn with a long sloping roof. A four-sided wooden silo with the corners filled in was built entirely inside the barn and was in use until 1968 when the concrete silo was built. In 1981 a metal implement shed was built.

Mamie and Fred Teetzel had five sons, Beverly, Howard, Archibald, Herman and Ross. Bev and Ross (both unmarried) live on the farm; Ross works for the railroad and Bev farms. Until 1965 Bev kept a herd of Holstein cows and shipped milk to the Carnation plant in Aylmer. At present he keeps beef cattle and grows corn, beans and hay. Archie lives in Mount Bridges & Howard in St. Thomas.

Fred Teetzel died in 1959, Mamie in 1977 and Herman in 1984.

In 1984, the year of the Ontario Bicentennial, it was discovered that this farm, first settled in 1816, was the farm in Southwold Township which had been continuously in the same family for the longest period of time.



42. Widened Two-Bay or Enclosed
Pennsylvania Barn.

SW $\frac{1}{2}$ Lot 16 SNBTR



Residence of: Mr. Bev Teetzel
R.R.3, Shedden.

The farm is now 93 acres instead of the original 100 because the east part of the village of Shedden and the Shedden Community Centre grounds are on the north-west end of the farm. Waugh Street in Shedden is named after William Waugh.

The present owner of this house, Bev Teetzel, has lived in the near-century home since he was born in 1920.

It was built in 1888 by his grandfather, (on his mother's side of the family) Abraham Waugh. Abraham built the house just when his daughter (Bev's mother) Mary Catherine was born. Mary Catherine Waugh left the homestead for a few years but returned when she

was married -- to Frederick Teetzel.

Bev grew up and worked the 93 acre cash crop and beef farm all his life. He took over ownership when his mother passed away in 1977 and lives there with his brother Ross.

Bev said the house hasn't required any extensive renovations over the years. He did put in a gas furnace, though, back in 1966.

Shedden Women's Institute

Voice of the Elgin Farmer
1986 B. Vicary

As mentioned in previous pages, William Waugh settled on lot 16 SNBTR in 1816. In 1840 he built a log school house on the N $\frac{1}{4}$ lot 16 fronting on Talbot St. In 1845 a larger frame school was built near the log school on land that is now Shedden Fair grounds. Next to the school was a huge elm tree of a very unusual shape; not terribly tall but with enormous spreading branches that nearly touched the ground. This tree was still alive when the property became the fairgrounds in 1950 but it died soon after of Dutch elm disease.

John and Alexander McDiarmid and their sister Elizabeth were pupils at Waugh's school when Richard Stafford, a very severe teacher, made them cut switches from this elm tree to be used for whippings when their school work was unsatisfactory.

This school was closed in 1866 and the pupils transferred to the brick school now the Old Schoolhouse Tearoom. (1986) The Waugh school became a residence and has now been torn down.

When William Waugh died in 1875 he gave the NE $\frac{1}{2}$ lot 16 to his son William Jr. William Jr. formed a partnership with William Wallis and built a sawmill on the north end of the property south-east of the present fairgrounds on land now owned by Douglas Orchard.

William Waugh Jr. continued to own the sawmill until at least 1886. He sold the property to Squire Brown and moved with his wife and two children to Oakland, California.

In 1921 Squire Brown sold the NE $\frac{1}{2}$ lot 16 to Nelson Bawtenheimer who in turn sold the E $\frac{1}{4}$ to Mrs. Alice Vicary in 1927. When Nelson Bawtenheimer died he left the N $\frac{1}{4}$ to his son Wilfred Bawtenheimer. In the late 1940's Wilfred Bawtenheimer sold twenty acres of the N $\frac{1}{4}$ fronting on Talbot St. to the Shedden Agricultural Society for the new fairgrounds. Douglas Orchard purchased the remaining 30 acres of the N $\frac{1}{4}$ at the same ^{time} and still operates it with his son, Bill.



Above: House built by Donald & Beth Vicary on the N $\frac{1}{4}$ lot 16 SNBtr in 1956-57.

Shedden Oct- 20 1886
 Messrs Alex & Andrew McDiarmid
 1886 To Wallis & Waugh Dr
 Oct 20 To amount rendered 38 21
 " one year's interest 3 05
 \$41 26
 Oct 22nd Recd Payment in
 full
 Wm J Wallis

This is a photocopy of an original bill from Wallis and Waugh Sawmill. It is dated October 20, 1886 and is for lumber purchased by Alexander and Andrew McDiarmid.

At the front of the SE $\frac{1}{2}$ of lot 16, fronting on the Edgeware Road, is a large Carolinian woodlot of about 24 acres, half on the Vicary farm and half on the Teetzel farm. Many a school and Sunday school outing has been held in these woods and to-day Brownies and Cubs and Scouts have used it as well. There was a natural clearing on the S $\frac{1}{4}$ of lot 16 where religious tent revival meetings were held for a couple of weeks each summer. Gipsys used it as a regular camping place as well. Mrs. Alice Vicary who was born in 1888 could remember these gatherings when she was a girl.

In 1956 Donald and Beth Turner Vicary bought one acre on the east corner of S $\frac{1}{4}$ lot 16 from Mrs. Alice Vicary and built a storey and a half house there. George Bogart poured the concrete basement with volunteer labour supplied by Alex Turner, Charlie Caswell, Tom McTavish, Bev Teetzel, Sigfred Knudsen and Donald Vicary. Elmer Auckland and John Silcox framed the house and put on the roof and siding. There are 3 bedrooms, livingroom, kitchen and bathroom downstairs and two bedrooms and a bathroom upstairs. Donald and Beth, with the help of Tom McTavish and Charlie Caswell, finished the inside of the house and Mr. and Mrs. Vicary and their small daughter, Alison moved in in the spring of 1957.

In 1959 Donald and Beth purchased the rest of the E $\frac{1}{4}$ lot 16 from his mother and barley, alfalfa and corn are grown on it. As well as the large woodlot at the front, there is a small woodlot and a large gully from the Big Creek at the back.

Three sons have been born since 1957; James, October 1957, Glenn, March 1960 and Leigh, August 1964. James married Sherry Fansher and lives in Union, Ont. They have two daughters. Glenn lives in St. Thomas and Leigh lives on S $\frac{1}{4}$ lot 17 SNBTR. Alison married Robert Purdy and they teach and live in Guelph, Ont.



Andrew McDiarmid House built in 1865. Picture taken in 1894 by Albert McDiarmid, photographer, Dutton, Ont. l to r: Mary Ann Baird Nicholl, Alice McDiarmid Vicary, Frances Baird McDiarmid. Note small porches over front and back doors.



The same house in 1902 showing new porch prefabricated in Norfolk County and brought by team and wagon to be assembled on the site. Owners Alexander and Frances McDiarmid are in the picture.



Reported to be approximately 115 years old, this lovely home belongs to Joe and Willie Van Der Maarel of R.R. 1 St. Thomas. The Van Der Maarels bought the house and farm in 1965 from Clarence Culver.

Mr. Culver's grandfather bought the farm in 1875. The original house located on the property burnt down, so the present structure (the main part of the current house) was purchased from Alec McDermott, a neighbouring farmer. The house was moved to its present location in 1899. In 1900, a back brick portion was added on, containing a kitchen, pantry, and a bedroom on the main floor, and an additional two bedrooms upstairs.

Aluminum siding was added to the home some time ago.

The present owners have renovated the rooms in their home, leaving all the original woodwork. A lovely oak staircase leads to the second floor, and a back staircase is located at the rear of the house.

The main floor of the home now contains a kitchen, dining room, bedroom, living room, laundry room and bath. Upstairs there are four bedrooms and a recreation room.

Two bay windows, located at the front and side, give the house an extra special charm, and compliment its style.

Surrounded by large shady trees and shrubbery, this lovely Elgin home retains the simple grace and charm of an era gone by.

In 1880 Alexander McDiarmid and his bride Frances Baird built the above house on the south corner of the S $\frac{1}{4}$ lot 17 SNBTR. It was closer to the road and almost in front of the present brick house built in 1865. Both Alice McDiarmid Vicary and her sister Amelia were born in the room with the bay window at the left of the picture.

On the death of his father in 1890, Mr. and Mrs. Alex McDiarmid and their daughter Alice moved into the brick house and his sister Marion and his mother moved into the frame house. When his mother died and his sister got married, the house was vacant.

In 1899 the house on the Culver farm, lot 20 NEBTR, was burned and Mr. Culver bought the house from Alex McDiarmid. The house was moved across the fields to avoid the ravines on Big Creek.

Muirkirk, 14 January 1880

3

Letters from Jessie

My attendance at school has increased from thirty the first day to fifty-five. I hope there'll no more come for I won't know where to put them. There are only three rows of desks in the school. I like the work very well and think I can see improvement in some of them. I hear of new scholars coming nearly every day. Heard yesterday that a fellow of 6 feet 7 in. was coming soon. Hope not.

I must go now to bed. Tell Violet I'll expect a letter soon. Mother will have plenty work with her help all gone.

With love to all
Your loving sister,
Jessie McDiarmid.

Alex. S. McDiarmid
Píngal, Ont.

Saturday A.M.

P.S. Busy washing. Jamie is going to the P.O.. Have 58 scholars now. Took tea with Mrs. Turner last night and went to prayer meeting. Please write soon - J. McD.

St. James Stopping-
Place.
4½ miles south of
Winnipeg

10:30 A.M. Jan. 2nd, 1884 50 to 55 degrees below zero.

My dear Fanny:

I should have written you long ago but, as usual, multifarious cares prevented, now I think I will have apologized enough when I tell you where I am prisoner. I came up to Winnipeg on Xmas Day arriving at 6:30 P.M. My return ticket (which cost me \$5.35) was "good" till to-day. Night before last was the coldest night in six years. - 59 below zero. It was not at all windy so by wrapping up a little we didn't feel the cold so very much. To-day, however, the wind is blowing a driving gale and I think the thermometer must be about 50 to 55 below zero. The train for Brandon leaves at 8:30 A.M. and Dr. A. drove me to the Sta. in time to reach it, as we supposed, but just as we were one block away we saw a train starting. He drove as near as he could to the train ahead of us and taking the weight to fasten his horse from the cutter, told me to help myself out. which I lost no time in doing. I had a parcel of dishes Emma is sending to Flossie and my valise was in the cutter. I can't tell if the horse was tied properly but think perhaps it was. With help from the Dr. and a brakeman I got on the last car and he said he'd send my valise. I had a borrowed shawl which I could not get off and which kept me from any graceful movements in getting on the train. I threw it off and called to the Dr. to get it which I think he did. I was out of breath and the brakeman said in a surly voice "That's no way to put this lady on!" "I know it but I can't help it" was the reply. I was just getting warm and had taken my seat for the forenoon when the conductor came along and when I